

SAVINGS SPOTLIGHT

Prices Effective September 1 - October 31, 2009

Don't miss these Great

FALL OUTDOORSMAN SPECIALS

Gerber Carnivore Blood Tracking Light™ Only
\$49.99

Page 13



Vista® Multi-Tool Only
\$69.99

Page 13

LEATHERMAN



Add a Camo Sleeve for **\$3.99 Each**

Clippix Plastic Spring Clamps As Low As

79¢

Page 4

New!



Quick Adjusting Wrench As Low As
\$13.49

Page 11



Lifetime guarantee

IRWIN
Industrial Tools

Manual Controls - Knobs, Handles and Hand Wheels

Clamps and Workholding

Tooling Components

Fasteners and Hardware

Leveling Devices and Vibration Control

Material Handling

Bearings and Power Transmission

Metalworking

Maintenance, Repair and Operations (MRO)

Pneumatics and Hydraulics

Structural Systems

Safety

Working Late?



Get the Industrial Products You Need 24/7
from anywhere on the Earth
at ReidSupply.com

Research
Explore
Download
Learn
Reid Knowledge Base



Find the Parts You Need - **FAST!**

ReidSupply.com lets you drill down to the exact part you need with just a few clicks using our **Smarter Search** technology with CAD drawings and product images.

New **CAD Search**

Download your **FREE CAD** drawings with the same **Smarter Search** technology as our parts search at ReidSupply.com.

**Nobody Will Serve
The Customer Better!**

DON'T MISS OUT at ReidSupply.com

Get your
FREE
catalog at
ReidSupply.com/catalog



Reid Supply's

DEAL of the **Day**

Get It Before It's Gone!

CAM LEVERS

Aluminum

Internal Thread

New!

Sale Price
As Low As **\$6⁹⁹**

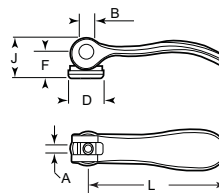

Cam lever handles allow for quick fastening and unfastening without the use of tools. They thread in like a regular fastener, but for the final clamp action, the cam handle is simply pushed downward. They are constructed of cast aluminum and the washer is fiberglass reinforced plastic.

Component Material									Sale Price Each	
Steel	Stainless	A	B	D	F	J	L	Steel	Stainless	
Inch										
BEQKCL-2	BEQKCL-8	10-32	.354	0.71	0.57	0.87	2.77	6.99	11.99	
BEQKCL-4	BEQKCL-10	1/4-20	.354	0.71	0.57	0.87	2.77	6.99	11.99	
BEQKCL-6	BEQKCL-12	9/16-18	.433	1.06	0.71	1.12	3.78	7.50	12.99	
Metric										
BEQKCL-14	BEQKCL-20	M5x.80	9	18	14.5	22	70.4	6.99	11.99	
BEQKCL-16	BEQKCL-22	M6x1.00	9	18	14.5	22	70.4	6.99	11.99	
BEQKCL-18	BEQKCL-24	M8x1.25	11	27	18	28.5	96	7.50	12.99	

ADJUSTABLE CAM LEVERS

Aluminum

External Thread

Sale Price
As Low As **\$8⁹⁹**

New!



Adjustable cam lever handles are just like the original cam lever except that the threaded stud can be adjusted with a flat head screwdriver. This allows the handle to be in the optimum position at all times.

Component Material									Sale Price Each	
Steel	Stainless	A	B	C	D	F	J	L	Steel	Stainless
Inch										
BEQKCL-166	BEQKCL-198	10-32	0.35	0.79	0.71	0.57	0.87	2.77	8.99	15.50
BEQKCL-168	BEQKCL-200	10-32	0.35	1.18	0.71	0.57	0.87	2.77	8.99	15.50
BEQKCL-170	BEQKCL-202	10-32	0.35	1.57	0.71	0.57	0.87	2.77	9.99	16.50
BEQKCL-172	BEQKCL-204	10-32	0.35	1.97	0.71	0.57	0.87	2.77	9.99	16.50
BEQKCL-174	BEQKCL-206	1/4-20	0.35	0.79	0.71	0.57	0.87	2.77	8.99	15.50
BEQKCL-176	BEQKCL-208	1/4-20	0.35	1.18	0.71	0.57	0.87	2.77	8.99	15.50
BEQKCL-178	BEQKCL-210	1/4-20	0.35	1.57	0.71	0.57	0.87	2.77	9.99	16.50
BEQKCL-180	BEQKCL-212	1/4-20	0.35	1.97	0.71	0.57	0.87	2.77	9.99	16.50
BEQKCL-182	BEQKCL-214	9/16-18	0.43	0.98	1.06	0.71	1.12	3.78	9.99	16.50
BEQKCL-184	BEQKCL-216	9/16-18	0.43	1.18	1.06	0.71	1.12	3.78	9.99	16.50
BEQKCL-186	BEQKCL-218	9/16-18	0.43	1.57	1.06	0.71	1.12	3.78	10.50	17.50
BEQKCL-188	BEQKCL-220	9/16-18	0.43	1.97	1.06	0.71	1.12	3.78	10.50	17.50
BEQKCL-190	BEQKCL-222	3/8-16	0.43	0.98	1.06	0.71	1.12	3.78	9.99	16.50
BEQKCL-192	BEQKCL-224	3/8-16	0.43	1.18	1.06	0.71	1.12	3.78	9.99	16.50
BEQKCL-194	BEQKCL-226	3/8-16	0.43	1.57	1.06	0.71	1.12	3.78	10.50	17.50
BEQKCL-196	BEQKCL-228	3/8-16	0.43	1.97	1.06	0.71	1.12	3.78	10.50	17.50
Metric										
BEQKCL-230	BEQKCL-262	M5x.80	9	20	18	14.5	22	70.4	8.99	15.50
BEQKCL-232	BEQKCL-264	M5x.80	9	30	18	14.5	22	70.4	8.99	15.50
BEQKCL-234	BEQKCL-266	M5x.80	9	40	18	14.5	22	70.4	9.99	16.50
BEQKCL-236	BEQKCL-268	M5x.80	9	50	18	14.5	22	70.4	9.99	16.50
BEQKCL-238	BEQKCL-270	M6x1.00	9	20	18	14.5	22	70.4	8.99	15.50
BEQKCL-240	BEQKCL-272	M6x1.00	9	30	18	14.5	22	70.4	8.99	15.50
BEQKCL-242	BEQKCL-274	M6x1.00	9	40	18	14.5	22	70.4	9.99	16.50
BEQKCL-244	BEQKCL-276	M6x1.00	9	50	18	14.5	22	70.4	9.99	16.50
BEQKCL-246	BEQKCL-278	M8x1.25	11	25	27	18	28.5	96	9.99	16.50
BEQKCL-248	BEQKCL-280	M8x1.25	11	30	27	18	28.5	96	9.99	16.50
BEQKCL-250	BEQKCL-282	M8x1.25	11	40	27	18	28.5	96	10.50	17.50
BEQKCL-252	BEQKCL-284	M8x1.25	11	50	27	18	28.5	96	10.50	17.50
BEQKCL-254	BEQKCL-286	M10x1.50	11	25	27	18	28.5	96	9.99	16.50
BEQKCL-256	BEQKCL-288	M10x1.50	11	30	27	18	28.5	96	9.99	16.50
BEQKCL-258	BEQKCL-290	M10x1.50	11	40	27	18	28.5	96	10.50	17.50
BEQKCL-260	BEQKCL-292	M10x1.50	11	50	27	18	28.5	96	10.50	17.50

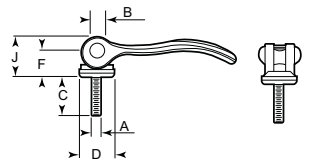

Screw driver slot for the fine adjustment of the tensioning lever

Attention GSA Customers

Note: This flier contains open market products, in addition to those included on the Reid Supply scheduled contract. Call **888.472.7343** today to see if you qualify for special pricing.



Contract Holder
FSS Contract GS-06F-0095S

CLAMPS

DuoKlamp®
One-Handed Clamping and Spreading

Sale Price
As Low As
\$18⁹⁹



New!

- Change from clamping to spreading by twisting the dial - no disassemblers
- Handle with pump level parallel to the rail
- Convenient one-handed operation
- All around clamping-in front of, behind and at the side of the rail



Cat No.	Throat Depth	Clamping Capacity	Clamping Force	Sale Price Each
BEQBLC-100	2 1/2	6	180	18.99
BEQBLC-101	2 1/2	12	180	19.99
BEQBLC-102	3 1/4	6	260	18.99
BEQBLC-103	3 1/4	12	260	19.99
BEQBLC-104	3 1/4	18	260	22.99
BEQBLC-105	3 1/4	24	260	23.99

Clippix Plastic Spring Clamps

- Made from durable, lightweight polyamide
- Ergonomic 2-component handle designed for comfort and firm grip

Cat No.	Throat Depth	Clamping Capacity	Sale Price Each
BEQBLC-300	3/4	3/4	0.79
BEQBLC-301	1 1/8	1	1.49
BEQBLC-302	1 1/2	1 3/4	1.69
BEQBLC-303	1 5/8	2	1.99
BEQBLC-304	1 1/2	2	1.69
BEQBLC-305	2 3/4	3	3.99

Sale Price
As Low As
79¢



New!



Clutch Style Bar Clamps

New!



Sale Price
As Low As
\$7⁹⁹

- Powder coated, ductile cast iron jaws
- 2-piece slip clutch plates
- Nickel plated, drawn serrated rail
- Non-marring pads on the top and bottom jaws
- Ergonomically shaped wood handle

Cat No.	Throat Depth	Clamping Capacity	Load Limit Lbs.	Sale Price Each
BEQBLC-200	2 1/2	6	600	7.99
BEQBLC-201	2 1/2	12	600	8.99
BEQBLC-202	2 1/2	18	600	10.99
BEQBLC-203	2 1/2	24	600	11.99
BEQBLC-204	2 1/2	30	600	12.99
BEQBLC-205	2 1/2	36	600	12.99
BEQBLC-206	3 1/2	12	1000	15.99
BEQBLC-207	3 1/2	18	1000	18.99
BEQBLC-208	3 1/2	24	1000	19.99
BEQBLC-209	5	12	1200	26.99
BEQBLC-210	5	18	1200	32.99
BEQBLC-211	5	24	1200	34.99



Steel Bar Clamps

Sale Price
As Low As
\$9⁹⁹

Used by homecrafters, cabinet-makers, woodworkers and metal-workers. The sliding head is threaded to accommodate the screw. All adjustments are made in the moveable sliding head, making this style fast-acting, easy to open and close and suitable for "close quarters" clamping. Strong, light-weight steel bars are rust-resistant. Multiple-Disc-Clutch holds securely at any point along the bar.

Cat No.	Max. Opening Capacity	Load Limit Lbs.	Sale Price Each
BEQAC-3706	6"	600	9.99
BEQAC-3712	12"	600	11.99
BEQAC-3718	18"	600	12.99
BEQAC-3724	24"	600	13.99
BEQAC-3736	36"	600	15.99



"Jorgensen"

New!

- Reach - 2-1/2" from edge of bar to center-line of screw
- Bar - 1/4" x 3/4" plated, round-edge, high carbon steel
- Castings - malleable and/or ductile iron; powder coated orange finish
- Screw - 3/8" diameter cold-drawn steel with special, smoothly cut U.S.S. threads
- Handle - varnished hardwood with plated steel ferrule
- Clutch discs - hardened, plated steel; two clutch discs and one clutch spring constitute the Multiple-Disc-Clutch

C-Clamps



Sale Price
As Low As
\$1²⁹

New!

This line of Pony® C-Clamps is an imported product manufactured in Pony's exclusive factory under strict guidelines that provides quality at an affordable price. Smoothly cut acme threads are protected with a bright plated finish. Ductile cast iron frames are powder-coated bright Pony orange for high visibility and lasting protection.

Cat No.	Opening Size	Throat Depth	Sale Price Each
BEQAC-2610	0-1	1	1.29
BEQAC-2615	0-1 1/2	1 1/2	1.99
BEQAC-2620	0-2	1	1.89
BEQAC-2622	0-2 1/2	1 3/8	2.99
BEQAC-2630	0-3	2	3.49
BEQAC-2640	0-4	3	5.99



VERTICAL HANDLE HOLD-DOWN CLAMPS

Series TC-2002, 2007, 2010

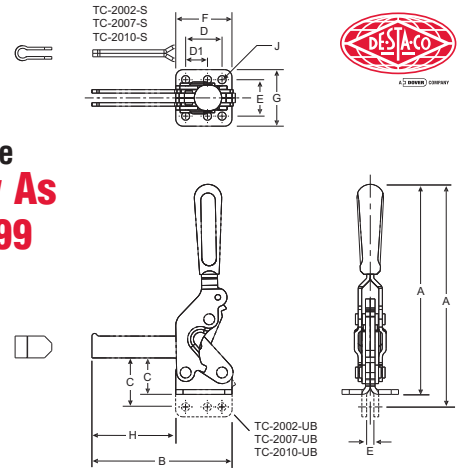
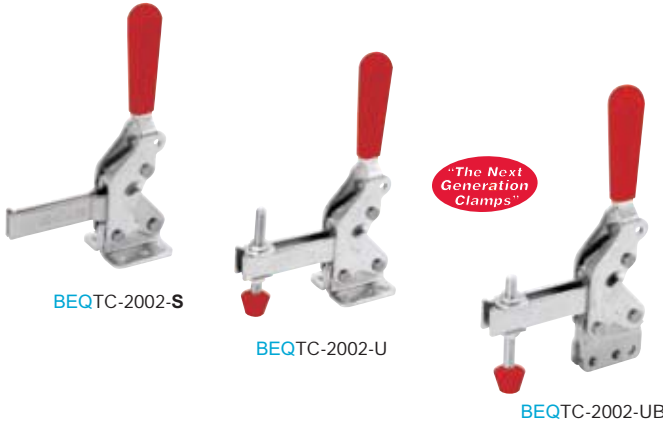

Sale Price
As Low As
\$11.99

Now you can save valuable space in all your applications without sacrificing holding capacity or clamp performance. The open "U" bar has a knob on the end to prevent the spindle from slipping off the end of the arm. Unique design delivers greater hand clearance in the open position, eliminating pinch points and improving safety and ergonomics. Clamp comes complete with ergonomic handle grip, two flanged washers and spindle assembly ("U" bar models only). All "S" bar models supplied with bolt retainer.

Cat. No.	A	B	C	D	D1	E	F	G	H	J	Handle Moves	Bar Opens	Holding Capacity (Lbs.)	Sale Price Each
BEQTC-2002-S	4.73	3.29	.95	.90	.50	1.06	1.36	1.52	1.93	.22	85	71	600	11.99
BEQTC-2002-U	4.73	3.29	.95	.90	.50	1.06	1.36	1.52	1.93	.22	85	71	600	11.99
BEQTC-2002-UB	5.07	3.29	1.27	.90	.50	.25	1.36	—	1.93	.22	85	71	600	12.99
BEQTC-2007-S	7.21	4.81	1.25	1.25	.75	1.25	1.93	1.94	2.88	.28	76	65	1000	14.99
BEQTC-2007-U	7.21	4.81	1.25	1.25	.75	1.25	1.93	1.94	2.88	.28	76	65	1000	14.99
BEQTC-2007-UB	7.64	4.81	1.68	1.25	.75	.25	1.93	—	2.88	.28	76	65	1000	15.99
BEQTC-2010-S	9.00	6.09	1.70	1.25	—	1.78	2.53	2.62	3.56	.34	83	69	1400	22.99
BEQTC-2010-U	9.00	6.09	1.70	1.25	—	1.78	2.53	2.62	3.56	.34	83	69	1400	22.99
BEQTC-2010-UB	9.612	6.09	2.20	1.25	—	.316	2.53	—	3.56	.34	83	69	1400	24.99

PULL-ACTION LATCH CLAMPS

Series TC-330, 351, 371, 381



BEQTC-351

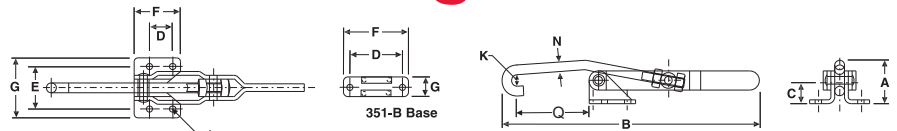

Sale Price
As Low As
\$9.99

Pull bar is threaded for convenient adjustment. Furnished with a thumb control lever.

Cat. No.	A	B	C	D	E	F	Drawing Movement	G	J	K	N	Q Min.	Q Max.	Holding Capacity (Lbs.)	Sale Price Each
Steel															
BEQTC-330	.90	5.64	.56	.50	1.23	1.00	2.31	1.69	.22	.31	.19	1.60	1.85	200	10.99
BEQTC-351	1.34	8.56	.75	.75	1.38	1.50	4.00	1.94	.20	.38	.31	1.75	2.18	375	9.99
BEQTC-351-B*	1.34	8.56	—	1.50	—	2.00	4.00	.56	.27	.44	.31	1.75	2.18	375	10.99
BEQTC-371	2.23	12.00	1.42	1.25	1.94	1.94	5.38	2.62	.34	.50	.39	2.02	2.83	750	22.99
BEQTC-381	2.71	13.45	1.81	1.13	2.38	2.13	6.13	3.38	.41	.63	.47	2.17	3.10	1,000	24.99
Stainless Steel															
BEQTC-330-SS	.90	5.64	.56	.50	1.23	1.00	2.31	1.69	.22	.31	.19	1.60	1.85	200	23.99
BEQTC-351-SS	1.34	8.56	.75	.75	1.38	1.50	4.00	1.94	.20	.44	.31	1.75	2.18	375	23.99
BEQTC-351-BSS*	1.34	8.56	—	1.50	—	2.00	4.00	.56	.27	.44	.31	1.75	2.18	375	23.99
BEQTC-371-SS	2.23	12.00	1.42	1.25	1.94	1.94	5.38	2.62	.34	.50	.39	2.02	2.83	750	59.99

*Narrow base

Note: Also available as Toggle-Lock Plus Models TC-351-R and TC-371-R.

FIXTURE CLAMPS

Save
10%

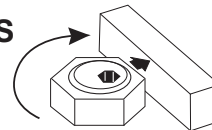

The Mitee-Bite™ clamping system combines strength, versatility and performance with economy and ease of use. Consisting of a cam action socket cap screw with a brass hex washer, set ups are simplified even for hard to hold parts. Its small size allows more parts per load on multiple series jobs. The low profile makes programming easier because there are no clamps to jump over. Fast to use (just 1/4 turn of screw loosens clamp) and no loose parts to set up each time. Economical— all six sides of the hex nut can be used. Available in six sizes for use on multiple part fixtures. Metric sizes are in millimeters. MB-10203 and MB-50207 are stainless steel.

Cat. No.	Screw Size	Thread Lgth.	Hex Size	Hex Ht.	Max. Holding Force Lbs.	Total Throw	No. of Clamps Per Pkg.	Sale Price Per Pkg.
Inch								
BEQMB-2	8-32	.350	.312	.110	205	.030	10	45.63
BEQMB-3	10-32	.340	.500	.160	350	.040	10	48.02
BEQMB-4	1/4-20	.470	.625	.190	800	.040	10	48.02
BEQMB-10203*	1/4-20	.470	.625	.190	—	.040	4	51.71
BEQMB-5	5/16-24	.460	.812	.190	750	.040	12	60.17
BEQMB-5C	5/16-18	.460	.812	.190	750	.040	12	60.17
BEQMB-6	3/8-16	.710	.812	.250	2,000	.050	10	55.35
BEQMB-8	1/2-13	.900	1.000	.375	4,000	.100	8	60.17
Metric								
BEQMB-50204	M4	9.6	7.93	2.80	93	.76	10	45.63
BEQMB-50206	M6	11.2	15.86	4.75	364	1.01	10	48.02
BEQMB-50208	M8	15.0	20.61	4.75	340	1.01	12	60.17
BEQMB-50207*	M8	15.0	20.60	6.35	—	1.01	4	69.26
BEQMB-50210	M10	19.0	20.61	6.35	910	1.52	10	55.35
BEQMB-50212	M12	22.8	25.38	9.52	1,818	2.03	8	60.17
BEQMB-50216	M16	28.5	30.13	12.69	2,720	2.54	4	45.63

*Stainless steel

WHEEL CHOCKS

Used for wedging and blocking tires to restrict movement of the wheel while vehicle is being loaded or unloaded at the dock for OSHA compliance.



Sale Price
As Low As
\$15⁹⁹

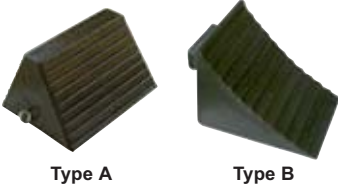

Molded Rubber
Type A & B - Made of nylon reinforced molded rubber provides maximum grip traction. Rubber resists tearing, abrasion, and ozone weathering. Safety engineered to minimize sliding.



Type C

Laminated
Type C - Made of cord reinforced serrated rubber on steel rods to provide a sure grip on concrete or paved surfaces. Large handle allows easy transport and placement of chock.



Type D

Molded Urethane
Type D - Bright orange for greater visibility. Incoming and outgoing drivers can easily see chock for added safety. Safety tread on chock face provides better grip and reduces slippage.



Type E

Extruded Aluminum
Type E - Allows easy handling with high tensile strength. Serrated surface grips tire, and triple-edged bottom grips ground.



Type F

Heavy-Duty Steel
Type F - Made of high strength annealed ductile cast iron. Maximum traction on any surface. Bottom teeth grip securely, resist slipping. Grip slot for easy pickup and positioning.



Type G

Security Chain and Hanger
Type G - Discourages theft and misplacement of wheel chocks. 15 ft. chain attaches wheel chocks to the hanger which bolts directly to the dock, securing chock permanently to the dock.

Cat. No.	Type	Description	Dimensions (W x H x D)	Weight	Sale Price Each
BEQVMC-RWC8	A	Molded Rubber	7 ⁵ / ₁₆ " x 6" x 8 ⁵ / ₁₆ "	10	15.99
BEQVMC-RWC11	B	Molded Rubber	7" x 7 ³ / ₄ " x 10"	13	22.99
BEQVMC-LWC14M	C	Rubber	10" x 5 ¹ / ₂ " x 10"	17	24.99
BEQVMC-URWC15	D	Urethane	8" x 8" x 11"	5	29.99
BEQVMC-EALUM7	E	Extruded Aluminum	7" x 8" x 10"	8	32.99
BEQVMC-FAB11	F	Fabricated	8" x 9" x 10 ³ / ₄ "	13	27.99
BEQVMC-OH15	G	Chain / Hanger	15 Foot Long	4	9.99

TIE DOWNS

Secure loads and protect them against damage from shifting while in transit. Meets all DOT, CHP and CVSA requirements. Ratchet assembly allows fast and easy adjustment.

LoadHugger™
Ratchet Tie Down Assemblies

Sale Price
As Low As **\$17⁹⁹**

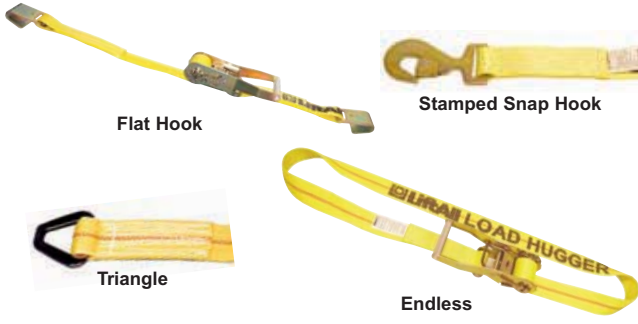

Cat. No.	Ultimate Strength (Lbs.)	Working Load Limit (Lbs.)	End Fitting	Length (ft.)	Sale Price Each
BEQLIF-103	5,000	1,600	Flat Hooks	27	17.99
BEQLIF-104	5,000	1,600	Flat Hooks	30	18.99
BEQLIF-105	5,000	1,600	Triangles	27	18.99
BEQLIF-106	5,000	1,600	Triangles	30	18.99
BEQLIF-107	5,000	1,600	Stamped Snap Hooks	27	19.99
BEQLIF-108	5,000	1,600	Stamped Snap Hooks	30	19.99
BEQLIF-109	5,000	1,600	Endless	27	17.99
BEQLIF-110	5,000	1,600	Endless	30	17.99
BEQLIF-111	10,000	3,300	Flat Hooks	27	19.99
BEQLIF-112	10,000	3,300	Flat Hooks	30	21.99
BEQLIF-113	10,000	3,300	Triangles	27	19.99
BEQLIF-114	10,000	3,300	Triangles	30	21.99
BEQLIF-115	10,000	3,300	Stamped Snap Hooks	27	24.99
BEQLIF-116	10,000	3,300	Stamped Snap Hooks	30	24.99
BEQLIF-117	10,000	3,300	Endless	27	18.99
BEQLIF-118	10,000	3,300	Endless	30	19.99

Adjust-A-Link™
Adjustable Chain Slings

SLINGS

Sale Price
As Low As **\$149⁹⁹**



The most easily adjustable and versatile chain sling available. Ideal for machine shop or maintenance departments. Made with grade 80 alloy chain. Proof tested and certified to comply with OSHA.

Cat. No.	Chain Size	Rate Capacities (lbs.)		Length (Ft.)	Sale Price Each
		Single @ 90°	Double @ 60°		
BEQLIF-95	7/32	2,100	3,600	6	149.99
BEQLIF-96	7/32	2,100	3,600	10	199.99
BEQLIF-97	9/32	3,500	6,100	6	239.99
BEQLIF-98	9/32	3,500	6,100	10	299.99
BEQLIF-99	3/8	7,100	12,300	10	399.99
BEQLIF-100	3/8	7,100	12,300	14	449.99
BEQLIF-101	1/2	12,000	20,800	10	649.99
BEQLIF-102	1/2	12,000	20,800	14	699.99



Save 10% on Gas Spring Products Shown Here

GAS SPRINGS

Fixed Force Gas Springs

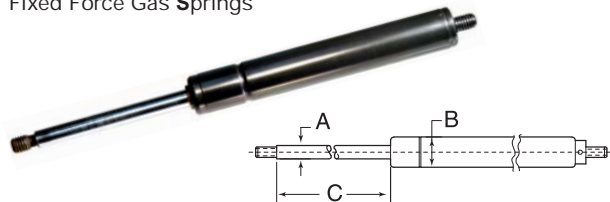

Patented multi-lobe seal significantly reduces gas leakage, tolerates shaft imperfections, vibrations and wide temperature variations. Body is made of heavy gauge steel and shaft is chromium plated steel. All have M6 x 1.0 threads. Three styles of end fittings are available below to fit these gas springs. Must be ordered separately.

Cat. No.	A	B	C	Compressed Size	Extended Size	P1 Force	Sale Price Each
BEQGAS-151	.24	.59	2.00	5.50	7.50	20	9.13
BEQGAS-152	.24	.59	2.00	5.50	7.50	40	9.13
BEQGAS-153	.24	.59	2.00	5.50	7.50	60	9.13
BEQGAS-154	.24	.59	2.00	5.50	7.50	80	9.13
BEQGAS-155	.24	.59	2.00	5.50	7.50	100	9.13
BEQGAS-161	.24	.59	3.15	6.45	9.60	20	9.13
BEQGAS-162	.24	.59	3.15	6.45	9.60	40	9.13
BEQGAS-163	.24	.59	3.15	6.45	9.60	60	9.13
BEQGAS-165	.24	.59	3.15	6.45	9.60	100	9.13
BEQGAS-171	.24	.59	3.50	8.50	12.00	20	9.25
BEQGAS-172	.24	.59	3.50	8.50	12.00	40	9.25
BEQGAS-173	.24	.59	3.50	8.50	12.00	60	9.25
BEQGAS-175	.24	.59	3.50	8.50	12.00	100	9.25
BEQGAS-101	.32	.75	3.50	8.40	11.90	20	14.04
BEQGAS-102	.32	.75	3.50	8.40	11.90	30	14.04
BEQGAS-103	.32	.75	3.50	8.40	11.90	60	14.04
BEQGAS-104	.32	.75	3.50	8.40	11.90	90	14.04
BEQGAS-105	.32	.75	3.50	8.40	11.90	120	14.04
BEQGAS-111	.32	.75	5.00	10.25	15.25	20	14.11
BEQGAS-112	.32	.75	5.00	10.25	15.25	30	14.11
BEQGAS-113	.32	.75	5.00	10.25	15.25	60	14.11
BEQGAS-114	.32	.75	5.00	10.25	15.25	90	14.11
BEQGAS-115	.32	.75	5.00	10.25	15.25	120	14.11
BEQGAS-121	.32	.75	6.00	11.00	17.00	20	14.26
BEQGAS-122	.32	.75	6.00	11.00	17.00	30	14.26
BEQGAS-123	.32	.75	6.00	11.00	17.00	60	14.26
BEQGAS-124	.32	.75	6.00	11.00	17.00	90	14.26
BEQGAS-125	.32	.75	6.00	11.00	17.00	120	14.26
BEQGAS-131	.32	.75	7.00	12.63	19.63	20	14.35
BEQGAS-132	.32	.75	7.00	12.63	19.63	30	14.35
BEQGAS-133	.32	.75	7.00	12.63	19.63	60	14.35
BEQGAS-134	.32	.75	7.00	12.63	19.63	90	14.35
BEQGAS-135	.32	.75	7.00	12.63	19.63	120	14.35
BEQGAS-141	.39	.87	10.00	17.80	27.80	100	19.40
BEQGAS-142	.39	.87	10.00	17.80	27.80	120	19.40
BEQGAS-143	.39	.87	10.00	17.80	27.80	150	19.40
BEQGAS-144	.39	.87	10.00	17.80	27.80	200	19.40

*P1 force is extended force

**Length including end fittings (center to center)

Adjustable Force Gas Springs

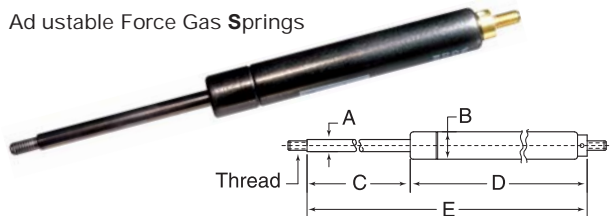

These adjustable gas springs are the perfect solution for small volume design or replacement applications, as the need to calculate the exact force required is eliminated. Each gas spring is charged at the factory to its maximum force value. Once installed in an application, a simple allen key (included) adjustment can be made to reduce the gas spring force, until the desired application function is reached. Manufactured from specially designed seals, nitrotec finished rods and powder epoxy paint finished tubes for maximum life and service. To order a complete gas spring, select a spring from the table below, then specify which end fittings you need. (Two end fittings per gas spring.)

Cat. No.	A	B	Stroke C	D	E	Supplied Force Lbs.	Thread Size	Sale Price Each
BEQGAS-1	.23	.59	2.36	3.94	6.30	90	M5x0.8	26.91
BEQGAS-2	.23	.59	3.94	5.51	9.45	90	M5x0.8	28.04
BEQGAS-3	.31	.71	3.94	6.46	10.39	146	M6x1.0	29.47
BEQGAS-4	.31	.71	5.91	8.43	14.33	146	M6x1.0	30.13
BEQGAS-5	.31	.71	7.87	10.39	18.27	146	M6x1.0	30.80
BEQGAS-7	.39	.91	11.81	13.39	25.20	270	M8x1.25	36.58

Plastic End Fitting



End fittings for gas springs. All are M6 x 1.0 thread.

Cat. No.	Description	Max P1 (Lbs.)	Sale Price Each
BEQGAS-201	Plastic End Fitting	150	.97

Metal End Fitting



Cat. No.	Description	Max P1 (Lbs.)	Sale Price Each
BEQGAS-202	Metal End Fitting	200	2.50

Fat Blade End Fittings



Die cast zinc.

Cat. No.	A	Sale Price Each
BEQGAS-211	.205-.210	1.28
BEQGAS-212	.260-.265	1.28
BEQGAS-213	.325-.330	1.28
BEQGAS-214	.405-.410	1.28

Mounting Brackets

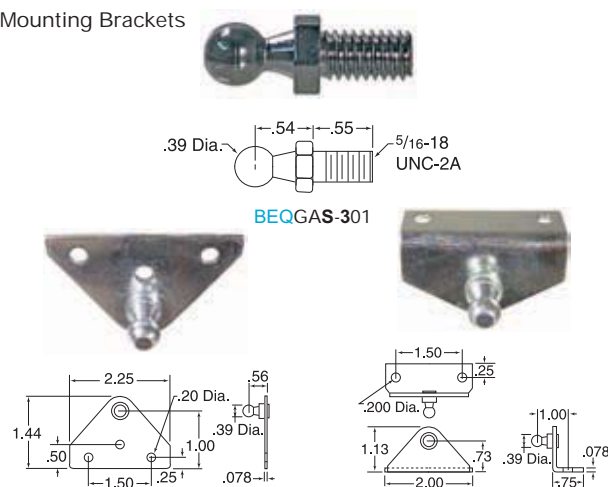

All are zinc plated steel designed for gas springs.

Cat. No.	Description	Sale Price Each	Cat. No.	Description	Sale Price Each	Cat. No.	Description	Sale Price Each
BEQGAS-301	Ball Stud	.70	BEQGAS-302	Flat Bracket	.70	BEQGAS-303	L-Bracket	.94

BEARINGS

Dri-Plane™
Bronze Sleeve Bearings



No Oil or Grease Needed for Lubrication

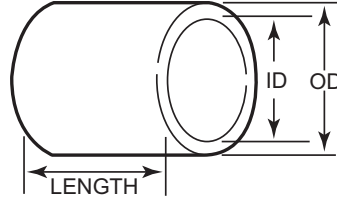

Expanded Line

"Dri-Plane™" bearings are produced to the exact standards of our SAE 841 Powdered Metal bearings, however, they have a graphite-based dry lubricant built right into the walls of the bearings. There is NO OIL or GREASE needed for lubrication, therefore, cleaner with no out gassing, and can operate in temperatures -30°F to + 700°F. They are ideal for furnace and oven applications. Also food processing and electrical equipment, exercise equipment, pharmaceuticals, vacuum processes, and glass manufacturing to name just a few.

ID or OD Size	Tolerance
to 1.510	-0.001
1.511 to 2.510	-0.0015
2.511 to 3.010	-0.002
3.011 to 4.010	-0.003
4.011 to 5.010	-0.004

Length Size	Tolerance
to 1.495	±.005
1.496 to 2.990	±.0075
2.991 to 4.995	±.010

ID	OD	Lqth.	Cat. No.	Price Each
1/8" ID x 1/4" OD Nominal				
0.1270	0.2530	1/8	BEQBNT-380	.70
0.1270	0.2530	1/4	BEQBNT-381	.73
0.1270	0.2530	3/8	BEQBNT-382	.76
3/16" ID x 1/4" OD Nominal				
0.1895	0.2530	1/4	BEQBNT-383	.33
0.1895	0.2530	3/8	BEQBNT-384	.40
0.1895	0.2530	1/2	BEQBNT-385	.46
3/16" ID x 5/16" OD Nominal				
0.1895	0.3155	1/4	BEQBNT-386	.36
0.1895	0.3155	3/8	BEQBNT-387	.41
0.1895	0.3155	1/2	BEQBNT-388	.40
1/4" ID x 5/16" OD Nominal				
0.2520	0.3155	1/4	BEQBNT-358	.46
0.2520	0.3155	1/2	BEQBNT-359	.65
0.2520	0.3155	3/4	BEQBNT-389	.59
1/4" ID x 3/8" OD Nominal				
0.2520	0.3780	1/4	BEQBNT-360	.35
0.2520	0.3780	3/8	BEQBNT-361	.47
0.2520	0.3780	1/2	BEQBNT-362	.46
0.2520	0.3780	5/8	BEQBNT-390	.44
0.2520	0.3780	3/4	BEQBNT-391	.55
0.2520	0.3780	7/8	BEQBNT-392	.60
0.2520	0.3780	1	BEQBNT-363	.98
1/4" ID x 1/2" OD Nominal				
0.2500	0.5030	1/2	BEQBNT-393	.71
0.2500	0.5030	3/4	BEQBNT-394	.93
0.2500	0.5030	1	BEQBNT-395	1.15
5/16" ID x 3/8" OD Nominal				
0.3145	0.3780	1/4	BEQBNT-396	.48
0.3145	0.3780	3/8	BEQBNT-397	.54
0.3145	0.3780	1/2	BEQBNT-398	.61
0.3145	0.3780	5/8	BEQBNT-399	.67
0.3145	0.3780	3/4	BEQBNT-400	.73
5/16" ID x 7/16" OD Nominal				
0.3125	0.4400	1/4	BEQBNT-401	.52
0.3125	0.4400	3/8	BEQBNT-402	.60
0.3125	0.4400	1/2	BEQBNT-403	.67
0.3125	0.4400	3/4	BEQBNT-404	.74
3/8" ID x 1/2" OD Nominal				
0.3770	0.5030	1/4	BEQBNT-364	2.34
0.3770	0.5030	3/8	BEQBNT-365	.52
0.3770	0.5030	1/2	BEQBNT-366	.57
0.3770	0.5030	5/8	BEQBNT-405	.58
0.3770	0.5030	3/4	BEQBNT-367	.90
0.3770	0.5030	7/8	BEQBNT-406	.71
0.3770	0.5030	1	BEQBNT-368	.92
0.3770	0.5030	1 1/4	BEQBNT-407	.88
3/8" ID x 9/16" OD Nominal				
0.3770	0.5655	1/2	BEQBNT-408	.92
0.3770	0.5655	3/4	BEQBNT-409	1.16
0.3770	0.5655	1	BEQBNT-410	1.47
0.3770	0.5655	1 1/4	BEQBNT-411	2.25
3/8" ID x 5/8" OD Nominal				
0.3770	0.6280	3/8	BEQBNT-412	1.02
0.3770	0.6280	1/2	BEQBNT-413	1.17
0.3770	0.6280	3/4	BEQBNT-414	1.31
7/16" ID x 5/8" OD Nominal				
0.4395	0.6280	1/2	BEQBNT-415	1.10
0.4395	0.6280	3/4	BEQBNT-416	1.24
0.4395	0.6280	1	BEQBNT-417	1.43
1/2" ID x 5/8" OD Nominal				
0.5020	0.6280	3/8	BEQBNT-418	.72
0.5020	0.6280	1/2	BEQBNT-373	.96
0.5020	0.6280	5/8	BEQBNT-419	.85
0.5020	0.6280	3/4	BEQBNT-374	1.29
0.5020	0.6280	1	BEQBNT-375	1.55
0.5020	0.6280	1 1/4	BEQBNT-420	1.42

ID	OD	Lqth.	Cat. No.	Price Each
1/2" ID x 3/4" OD Nominal				
0.5020	0.7530	3/8	BEQBNT-369	.55
0.5020	0.7530	1/2	BEQBNT-370	.71
0.5020	0.7530	5/8	BEQBNT-421	.57
0.5020	0.7530	3/4	BEQBNT-371	.80
0.5020	0.7530	1	BEQBNT-372	1.02
0.5020	0.7530	1 1/4	BEQBNT-422	.89
9/16" ID x 3/4" OD Nominal				
0.5645	0.7530	3/4	BEQBNT-423	1.10
0.5645	0.7530	1 1/4	BEQBNT-424	1.15
5/8" ID x 3/4" OD Nominal				
0.6270	0.7530	1/2	BEQBNT-425	.95
0.6270	0.7530	5/8	BEQBNT-426	.97
0.6270	0.7530	3/4	BEQBNT-427	.99
0.6270	0.7530	7/8	BEQBNT-428	1.01
0.6270	0.7530	1	BEQBNT-376	1.39
0.6270	0.7530	1 1/4	BEQBNT-429	1.17
5/8" ID x 13/16" OD Nominal				
0.6270	0.8165	1/2	BEQBNT-430	1.10
0.6270	0.8165	3/4	BEQBNT-431	1.25
0.6270	0.8165	1	BEQBNT-432	1.38
5/8" ID x 7/8" OD Nominal				
0.6270	0.8790	1/2	BEQBNT-433	1.10
0.6270	0.8790	5/8	BEQBNT-434	1.20
0.6270	0.8790	3/4	BEQBNT-435	1.30
0.6270	0.8790	1	BEQBNT-436	1.38
3/4" ID x 7/8" OD Nominal				
0.7520	0.8790	1/2	BEQBNT-437	.99
0.7520	0.8790	5/8	BEQBNT-438	1.09
0.7520	0.8790	3/4	BEQBNT-439	1.19
0.7520	0.8790	1	BEQBNT-440	1.27
0.7520	0.8790	1 1/4	BEQBNT-441	1.50
3/4" ID x 1" OD Nominal				
0.7520	1.0040	1/2	BEQBNT-442	1.19
0.7520	1.0040	5/8	BEQBNT-443	1.28
0.7520	1.0040	3/4	BEQBNT-444	1.36
0.7520	1.0040	1	BEQBNT-377	2.02
0.7520	1.0040	1 1/4	BEQBNT-445	1.79
0.7520	1.0040	1 1/2	BEQBNT-446	2.08
0.7520	1.0040	1 3/4	BEQBNT-447	2.41
0.7520	1.0040	2 1/2	BEQBNT-448	4.24
3/4" ID x 1 1/8" OD Nominal				
0.7520	1.1290	1	BEQBNT-449	2.81
7/8" ID x 1" OD Nominal				
0.8770	1.0040	1	BEQBNT-450	1.40
7/8" ID x 1 1/8" OD Nominal				
0.8770	1.1290	3/4	BEQBNT-451	1.77
0.8771	1.1291	1	BEQBNT-452	1.97
0.8772	1.1292	1 1/4	BEQBNT-453	2.46
1" ID x 1 1/4" OD Nominal				
1.0030	1.2540	1/2	BEQBNT-454	1.54
1.0030	1.2540	3/4	BEQBNT-455	1.77
1.0030	1.2540	1	BEQBNT-379	2.58
1.0030	1.2540	1 1/4	BEQBNT-456	2.31
1.0030	1.2540	1 1/2	BEQBNT-457	2.69
1 1/2" ID x 1 3/8" OD Nominal				
1.1280	1.3790	1	BEQBNT-458	2.22
1 1/4" ID x 1 1/2" OD Nominal				
1.2535	1.5040	3/4	BEQBNT-459	2.08
1.2535	1.5040	1	BEQBNT-460	2.38
1.2535	1.5040	1 1/2	BEQBNT-461	3.06
1 1/2" ID x 1 3/4" OD Nominal				
1.5040	1.7550	1	BEQBNT-462	2.91
1.5040	1.7550	1 1/2	BEQBNT-463	3.91
1.5040	1.7550	2	BEQBNT-464	5.17
2" ID x 2 1/4" OD Nominal				
2.0040	2.2550	1	BEQBNT-465	5.67
2.0040	2.2550	1 1/2	BEQBNT-466	6.06
2.0040	2.2550	2	BEQBNT-467	7.30
2" ID x 2 3/8" OD Nominal				
2.0040	2.3800	1 1/2	BEQBNT-468	8.92
2.0040	2.3800	2	BEQBNT-469	11.22

BEARINGS

Food Grade
841ECO Bronze Sleeve Bearings



New!

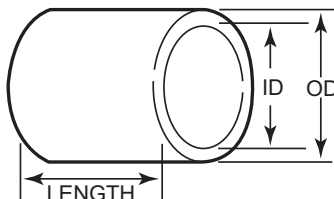

ID or OD Size	Tolerance
to 1.510	-0.001
1.511 to 2.510	-0.0015
2.511 to 3.010	-0.002
3.011 to 4.010	-0.003
4.011 to 5.010	-0.004

Length Size	Tolerance
to 1.495	±.005
1.496 to 2.990	±.0075
2.991 to 4.895	±.010

These Powdered Metal Bearings are impregnated with a food grade lubricant which meets USDA H-1 standards and is RoHS compliant. Ideal for food processing, dairy and other such machinery. Temperature range is -30°F to +420°F.

ID	OD	Lgth.	Cat. No.	Price Each
1 8	ID x 1 4 OD Nominal			
	0.1270 0.2530	1/8	BEQBNT-500	.63
	0.1270 0.2530	1/4	BEQBNT-501	.34
	0.1270 0.2530	3/8	BEQBNT-502	.49
3 16	ID x 1 4 OD Nominal			
	0.1895 0.2530	1/4	BEQBNT-503	.28
	0.1895 0.2530	3/8	BEQBNT-504	.32
	0.1895 0.2530	1/2	BEQBNT-505	.33
3 16	ID x 5 16 OD Nominal			
	0.1895 0.3155	1/4	BEQBNT-506	.33
	0.1895 0.3155	3/8	BEQBNT-507	.29
	0.1895 0.3155	1/2	BEQBNT-508	.31
1 4	ID x 5 16 OD Nominal			
	0.2520 0.3155	1/4	BEQBNT-509	.28
	0.2520 0.3155	1/2	BEQBNT-510	.29
	0.2520 0.3155	3/4	BEQBNT-511	.43
1 4	ID x 3 8 OD Nominal			
	0.2520 0.3780	1/4	BEQBNT-512	.37
	0.2520 0.3780	3/8	BEQBNT-513	.33
	0.2520 0.3780	1/2	BEQBNT-514	.37
	0.2520 0.3780	5/8	BEQBNT-515	.40
	0.2520 0.3780	3/4	BEQBNT-516	.40
	0.2520 0.3780	7/8	BEQBNT-517	.40
	0.2520 0.3780	1	BEQBNT-518	.40
1 4	ID x 1 2 OD Nominal			
	0.2500 0.5030	1/2	BEQBNT-519	.52
	0.2500 0.5030	3/4	BEQBNT-520	.70
	0.2500 0.5030	1	BEQBNT-521	.82
5 16	ID x 3 8 OD Nominal			
	0.3145 0.3780	1/4	BEQBNT-522	.70
	0.3145 0.3780	3/8	BEQBNT-523	.33
	0.3145 0.3780	1/2	BEQBNT-524	.33
	0.3145 0.3780	5/8	BEQBNT-525	.46
	0.3145 0.3780	3/4	BEQBNT-526	.58
5 16	ID x 7 16 OD Nominal			
	0.3125 0.4400	1/4	BEQBNT-527	.72
	0.3125 0.4400	3/8	BEQBNT-528	.72
	0.3125 0.4400	1/2	BEQBNT-529	.80
	0.3125 0.4400	3/4	BEQBNT-530	.85
3 8	ID x 1 2 OD Nominal			
	0.3770 0.5030	1/4	BEQBNT-531	.25
	0.3770 0.5030	3/8	BEQBNT-532	.28
	0.3770 0.5030	1/2	BEQBNT-533	.29
	0.3770 0.5030	5/8	BEQBNT-534	.37
	0.3770 0.5030	3/4	BEQBNT-535	.67
	0.3770 0.5030	7/8	BEQBNT-536	.51
	0.3770 0.5030	1	BEQBNT-537	.47
	0.3770 0.5030	1 1/4	BEQBNT-538	.51
3 8	ID x 9 16 OD Nominal			
	0.3770 0.5655	1/2	BEQBNT-539	.61
	0.3770 0.5655	3/4	BEQBNT-540	.73
	0.3770 0.5655	1	BEQBNT-541	.83
	0.3770 0.5655	1 1/4	BEQBNT-542	1.76
3 8	ID x 5 8 OD Nominal			
	0.3770 0.6280	3/8	BEQBNT-543	.70
	0.3770 0.6280	1/2	BEQBNT-544	.65
	0.3770 0.6280	3/4	BEQBNT-545	.79
7 16	ID x 5 8 OD Nominal			
	0.4395 0.6280	1/2	BEQBNT-546	.61
	0.4395 0.6280	3/4	BEQBNT-547	.72
	0.4395 0.6280	1	BEQBNT-548	.84
1 2	ID x 5 8 OD Nominal			
	0.5020 0.6280	3/8	BEQBNT-549	.32
	0.5020 0.6280	1/2	BEQBNT-550	.37
	0.5020 0.6280	5/8	BEQBNT-551	.45
	0.5020 0.6280	3/4	BEQBNT-552	.47
	0.5020 0.6280	1	BEQBNT-553	.57
	0.5020 0.6280	1 1/4	BEQBNT-554	.65

ID	OD	Lgth.	Cat. No.	Price Each
1 2	ID x 3 4 OD Nominal			
	0.5020 0.7530	3/8	BEQBNT-555	.55
	0.5020 0.7530	1/2	BEQBNT-556	.61
	0.5020 0.7530	5/8	BEQBNT-557	.68
	0.5020 0.7530	3/4	BEQBNT-558	.78
	0.5020 0.7530	1	BEQBNT-559	.97
	0.5020 0.7530	1 1/4	BEQBNT-560	1.20
9 16	ID x 3 4 OD Nominal			
	0.5645 0.7530	3/4	BEQBNT-561	1.01
	0.5645 0.7530	1 1/4	BEQBNT-562	1.10
5 8	ID x 3 4 OD Nominal			
	0.6270 0.7530	1/2	BEQBNT-563	.47
	0.6270 0.7530	5/8	BEQBNT-564	.53
	0.6270 0.7530	3/4	BEQBNT-565	.59
	0.6270 0.7530	7/8	BEQBNT-566	.62
	0.6270 0.7530	1	BEQBNT-567	.68
	0.6270 0.7530	1 1/4	BEQBNT-568	.79
5 8	ID x 13 16 OD Nominal			
	0.6270 0.8165	1/2	BEQBNT-569	.72
	0.6270 0.8165	3/4	BEQBNT-570	.88
	0.6270 0.8165	1	BEQBNT-571	.98
5 8	ID x 7 8 OD Nominal			
	0.6270 0.8790	1/2	BEQBNT-572	.68
	0.6270 0.8790	5/8	BEQBNT-573	.80
	0.6270 0.8790	3/4	BEQBNT-574	.92
	0.6270 0.8790	1	BEQBNT-575	1.16
3 4	ID x 7 8 OD Nominal			
	0.7520 0.8790	1/2	BEQBNT-576	.55
	0.7520 0.8790	5/8	BEQBNT-577	.56
	0.7520 0.8790	3/4	BEQBNT-578	.61
	0.7520 0.8790	1	BEQBNT-579	.75
	0.7520 0.8790	1 1/4	BEQBNT-580	1.12
3 4	ID x 1 OD Nominal			
	0.7520 1.0040	1/2	BEQBNT-581	.77
	0.7520 1.0040	5/8	BEQBNT-582	.90
	0.7520 1.0040	3/4	BEQBNT-583	1.00
	0.7520 1.0040	1	BEQBNT-584	1.27
	0.7520 1.0040	1 1/4	BEQBNT-585	1.54
	0.7520 1.0040	1 1/2	BEQBNT-586	1.81
	0.7520 1.0040	3/4	BEQBNT-587	2.08
	0.7520 1.0040	2 1/2	BEQBNT-588	3.24
3 4	ID x 1 1 8 OD Nominal			
	0.7520 1.1290	1	BEQBNT-589	2.75
7 8	ID x 1 OD Nominal			
	0.8770 1.0040	1	BEQBNT-590	1.15
7 8	ID x 1 1 8 OD Nominal			
	0.8770 1.1290	3/4	BEQBNT-591	1.34
	0.8771 1.1291	1	BEQBNT-592	1.65
	0.8772 1.1292	1 1/4	BEQBNT-593	2.13
1	ID x 1 1 4 OD Nominal			
	1.0030 1.2540	1/2	BEQBNT-594	.89
	1.0030 1.2540	3/4	BEQBNT-595	1.35
	1.0030 1.2540	1	BEQBNT-596	1.57
	1.0030 1.2540	1 1/4	BEQBNT-597	1.88
	1.0030 1.2540	1 1/2	BEQBNT-598	2.23
1 1 2	ID x 1 3 8 OD Nominal			
	1.1280 1.3790	1	BEQBNT-599	1.80
1 1 4	ID x 1 1 2 OD Nominal			
	1.2535 1.5040	3/4	BEQBNT-600	1.54
	1.2535 1.5040	1	BEQBNT-601	1.95
	1.2535 1.5040	1 1/2	BEQBNT-602	2.78
1 1 2	ID x 1 3 4 OD Nominal			
	1.5040 1.7550	1	BEQBNT-603	2.41
	1.5040 1.7550	1 1/2	BEQBNT-604	3.45
	1.5040 1.7550	2	BEQBNT-605	4.28
2	ID x 2 1 4 OD Nominal			
	2.0040 2.2550	1	BEQBNT-606	4.05
	2.0040 2.2550	1 1/2	BEQBNT-607	5.30
	2.0040 2.2550	2	BEQBNT-608	6.32
2	ID x 2 3 8 OD Nominal			
	2.0040 2.3800	1 1/2	BEQBNT-609	7.59
	2.0040 2.3800	2	BEQBNT-610	9.46

MICROMETERS

**Digimatic Micrometers
293 Series**

With Dust/Water Protection Conforming to IP65 Level

- IP65 protection level, enabling use in environments exposed to cutting oil, etc*
- Measurement data output function is available with a water-resistant connection cable
- Auto power ON/OFF function
- Certificate of inspection** is included (50mm/2" or less range models)
- With a standard bar except for 0-25mm/0-1" model
- Supplied in fitted case. Plastic case up to 150mm/6", Wooden box over 150mm/6"

*Anti-corrosion treatment is required after use

**It is not the type used to obtain calibration certificates

New!



Mitutoyo

IP65

**Sale Price
As Low As
\$129⁹⁹**

Cat No.	Range	Accuracy	Type	Sale Price Each
BEQMI-293-340	0-1	±.00005	Ratchet - No Output	129.99
BEQMI-293-330	0-1	±.00005	Ratchet - Output	199.99
BEQMI-293-335	0-1	±.00005	Friction Thimble - Output	199.99
BEQMI-293-344	0-1	±.00005	Ratchet Thimble - No Output	129.99
BEQMI-293-331	1-2	±.00005	Ratchet - Output	229.99
BEQMI-293-345	1-2	±.00005	Ratchet Thimble - No Output	169.99
BEQMI-293-332	2-3	±.00005	Ratchet - Output	299.99

6" Digital Micrometers

**Sale Price
As Low As
\$59⁹⁹**



**Reid
SELECT**

- Zero setting at any position
- Big .43" (11 mm) high LCD display
- Instant SAE/metric conversion
- Graduations: 0.0005"/0.01 mm
- Includes fitted case with two batteries
- Ratchet type, no output
- Full one year warranty

Cat. No.	Description	Range	Sale Price Each
BEQYPI-4	Digital Micrometer in Fitted Case	0-25mm	59.99
BEQYPI-5	Digital Micrometer in Fitted Case	25-50mm	79.99
BEQYPI-2	Replacement Battery		.99

IDS

**Sale Price
\$124⁹⁹**



DIGIMATIC INDICATORS

Mitutoyo

- Zero setting at any position
- Big .43" (11 mm) high LCD display
- Instant SAE/metric conversion
- Graduations: 0.0005"/0.01 mm
- Includes fitted case with two batteries
- Ratchet type, no output
- Full one year warranty

Cat. No.	Description	Range	Display	Sale Price Each
BEQMI-543-683	Lug on Center Back	0-.5"	.0005	124.99
BEQMI-543-683B	Flat Back	0-.5"	.0005	124.99
BEQMI-905338	1 Meter Connecting Cable			34.49

CALIPERS

**Dial Calipers
505 Series
Inch and Metric**

**Sale Price
As Low As
\$79⁷⁹**



Mitutoyo

- Stainless steel
- Thumb roller
- Supplied in fitted carrying case

These dial calipers have been designed with a new dial movement to give an ultra smooth feel and to provide extra shock protection for the gear train. To increase tool life a TiN coating has been applied to the beam wear surfaces on the 6" and 8" calipers.

Cat. No.	Range	Resolution	Range per Rev.	Depth of Jaws	Sale Price Each
BEQMI-505-717	0-6	.001	.200	1 ⁹ / ₁₆	79.79
BEQMI-505-675	0-6	.001	.100	1 ⁹ / ₁₆	88.20
BEQMI-505-712*	0-6	.001	.100	1 ⁹ / ₁₆	141.12
BEQMI-505-676	0-8	.001	.100	1 ¹⁵ / ₁₆	127.68
BEQMI-505-720	0-12	.001	.200	2 ¹ / ₂	178.08
BEQMI-505-677	0-12	.001	.100	40mm	190.68

*OD/ID carbide jaw

Fractional Digital Caliper

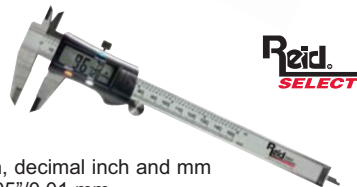

**Reid
SELECT**

- 3 readouts; fractional inch, decimal inch and mm
- Graduations: 1/128"/0.0005"/0.01 mm
- Zero setting at any position
- Big .5" (12 mm) high LCD display
- Enhanced stable display with quick sliding
- Instant SEA/metric conversion
- Includes fitted case with two batteries
- Full one year warranty

**Sale Price
As Low As
\$19⁹⁹**

Cat. No.	Description	Range	Sale Price Each
BEQYPI-9	Caliper in Fitted Case	0-6" (0-150mm)	19.99
BEQYPI-10	Caliper in Fitted Case	0-8" (0-200mm)	29.99
BEQYPI-2	Replacement Battery		.99

6" Big Digit Premium Stainless Caliper



**Reid
SELECT**

- Zero setting at any position
- Big .43" (11mm) high LCD display
- Instant SAE/ metric conversion
- Graduations: 0.0005"/0.01mm
- Includes fitted case with two batteries
- Full one year warranty

**Sale Price
As Low As
\$19⁹⁹**

Cat. No.	Description	Range	Sale Price Each
BEQYPI-1	Digital Caliper in Fitted Case	0-6" (0-150mm)	19.99
BEQYPI-3	Digital Caliper in Fitted Case	0-8" (0-200mm)	29.99
BEQYPI-2	Replacement Battery		.99

MA NETS

Basic Lift Magnet



- Full width cam release
- Large lift lug
- Light weight design
- Durable stainless steel casing
- Heat resistant up to 300°F (148°C)
- 2:1 design factor

New!

Sale Price As Low As \$199⁹⁹

Permanent lift magnet for a broad range of lifting applications. The Basic Lift magnet has a full width cam release and a tall lift lug for easy use with crane hooks and sling.

Cat. No.	Lifting Capacity	Overall Size W x L x H	Magnet Size W x L x H	Weight	Sale Price Each
BEQIM-491	400	6 1/2 x 6 1/2 x 5	6" x 3 3/8 x 1 5/8	13	199.99
BEQIM-492	1000	6 1/2 x 9 1/2 x 5	6" x 6 1/2 x 1 5/8	18	299.99
BEQIM-493	1500	6 1/2 x 13 3/4 x 5	6 x 10 3/4 x 1 5/8	28	399.99

rip Stick Retriever

Sale Price As Low As \$44⁹⁹



Cat. No.	Type	Lifting Capacity	Length nch	Width in	Ht. n	Sale Price Each
BEQIM-489	Ceramic	12.5	14	1 3/8	7/8	44.99
BEQIM-490	Rare Earth	43.5	14	1 3/8	7/8	59.99

- Retrieve hot parts
- Keep hands out of press
- Reduce employee injury
- 10° angled handle

New!

ON OFF Welding S uares and Hooks

MagS uares

Simple, fast work-holding on multiple sides. Eliminate the need for tedious clamping. Pre-tapped holes on all sides for mounting jigs, fixtures, forms, etc.

Magnetic Hanging Hooks

Perfect for temporary holding of lines, hoses, lights, tools and more. Quickly secure and hold to just about anything, anywhere.



M-513

New!

Sale Price As Low As \$29⁹⁹

Switchable ON/OFF Rare Earth magnets are extremely powerful. ON/OFF magnets easily allows debris to fall away. Can be used on flat or round steel or cast iron. Non-marring hold.

Cat. No.	Hold Lbs.	Ht. n.	Width n.	Length n.	Sale Price Each
MagS uares					
BEQIM-510	150	2 1/2	1 1/2	8	29.99
BEQIM-511	550	4	2 1/2	8	96.75
BEQIM-512	550	4	3 1/4	12	224.63
Magnetic Hanging Hooks					
BEQIM-513	25	4	1 1/2 Dia.	—	29.99
BEQIM-514	40	4	2 3/4 Dia.	—	59.99

uick Ad usting Wrench

Lifetime guarantee

Parallel jaws with smooth surfaces. Precise scale markings. Grooved internal jaw. Sliding lever. ProTouch™ grips provide maximum comfort and reduce hand fatigue. Hang hole for easy wall storage. Lifetime guarantee.

Cat. No.	Lgth	Width	Sale Price Each
BEQATC-2078601	8	1	13.49
BEQATC-2078602	8	1	13.49
BEQATC-2078605	10	1 1/4	16.49
BEQATC-2078607	10	1 1/4	16.49
BEQATC-2078609	12	1 1/2	19.99
BEQATC-2078611	12	1 1/2	19.99

WRENCHES



Sale Price As Low As \$13⁴⁹ IRWIN Industrial Tools



BATTER ES

ltra Pro



180381

New!

Sale Price As Low As \$7⁹⁹

Rayovac batteries are the #1 selling industrial battery based on top industrial distributors. Whether you need shrink packaging (great for contract or bid business) or contractor packaging to help organize and protect batteries from damage and short circuiting, Rayovac has a program to fit your needs.

Cat. No.	Description	Sale Price Each
BEQ180381	Alkaline AA Size Reclosable 24 Pack	11.49
BEQ180382	Alkaline AAA Size Reclosable 18 Pack	7.99
BEQ180383	Alkaline C Size Reclosable 12 Pack	10.49
BEQ180384	Alkaline D Size Reclosable 12 Pack	12.99
BEQ180385	Alkaline 9-Volt Reclosable 8 Pack	12.99

HAND CLEANER

Fast Orange® Lotion Hand Cleaner and Dispenser



Sale Price As Low As \$14⁹⁹

This petroleum free solvent formula cleans tough grease and grime with natural orange oil. Contains aloe, lanolin and jojoba to condition skin. Leaves hands with a fresh scent of orange. Available in smooth lotion or pumice formula. USDA approved.

Cat. No.	Container	Sale Price Each
Fine Pumice Formula		
BEQLOC-25218	1 Gal. Bottle with Pump	14.99
BEQLOC-25104	1 Gal. Flat Top Bottle	14.99
Smooth Formula		
BEQLOC-23218	1 Gal. Bottle with Pump	14.99
Dispenser		
BEQLOC-95140	Pull Type, Wall Mount Dispenser	24.99

TOOL OR KEY RETRACTORS

48" Retractor
Kevlar® Cord

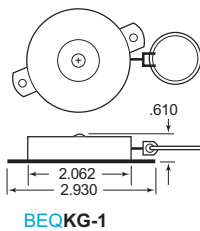

BEQKG-1

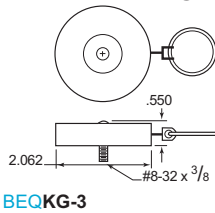

BEQKG-3



Sale Price
Only \$9⁹⁹
Each

48" nylon covered stainless steel cable. 8-10 ounces of retractor force. Includes 1-1/8" diameter split ring for holding keys or gauges. Available with mounting bracket, threaded stud or belt clip. Textured chrome case.

Cat. No.	Description	Sale Price Each
BEQKG-1	Tool or key retractor w/mounting bracket	9.99
BEQKG-2	Tool or key retractor w/Kevlar Cord and belt clip	9.99
BEQKG-3	Tool or key retractor w/threaded stud	9.99

MACHINIST'S CALCULATOR



Sale Price
Cat. No.
BEQTIS-MC-20
\$38⁹⁵

Determine the best machine speed and feed rates for all tools and material accurately with complete portability. Modern high-speed equipment combined with vastly superior tools yield production and quality advantages like never before. The machinist's calculator provides operators a hand-held device to determine startup parameters in the machine/tool/material equation. Achieve optimum production; minimize tool damage and wasted pieces. Built-in formulas return proper RPM, SFM, IPM, FPT, and CT (Cut Time) for all operations on all kinds of set-ups for machine, materials and tools. Calculator has prompting formats and yields time estimates. Perfect educational tool that fits in palm or pocket.

MULTI-TOOLS

Crunch®

14 Tools in One
100% Stainless Steel
Includes Black Leather Sleeve

- Locking Pliers
- Wire Cutters
- Hard-wire Cutters
- Serrated Knife
- Wood/Metal File
- Small Screwdriver
- Medium Screwdriver
- Large Screwdriver
- Phillips Screwdriver
- Ruler
- Bottle Opener
- Hex Bit Driver
- Wire Stripper
- Lanyard Ring



Sale Price
Cat. No.
BEQLTG-30
\$89⁹⁹

Squirt®P4

Sale Price
Only \$29⁹⁹

- 12 Tools in One
- Needle nose Pliers
 - Regular Pliers
 - Straight Knife
 - Wire Cutters
 - Extra Small Screwdriver
 - Medium Screwdriver
 - Flat Phillips Screwdriver
 - Bottle Opener
 - Key Ring Attachment
 - Awl
 - Single Cut File
 - Cross Cut File



Add a Genuine
Leather Sleeve
for \$1.99

Cat. No.	Description	Color	Sale Price Each
BEQLTG-25	2.25" Multi-Tool	Red	29.99
BEQLTG-20	Squirt Leather Sleeve	Black	1.99

HAMMER

Brass Hammer

New!



Sale Price
Cat. No.
BEQMNT-3192
\$14⁹⁹

- 32oz precision-machined solid brass head
- Non-sparking head will not mar finished steel surfaces
- Fiberglass handle

FALL OUTDOORSMAN SPECIALS

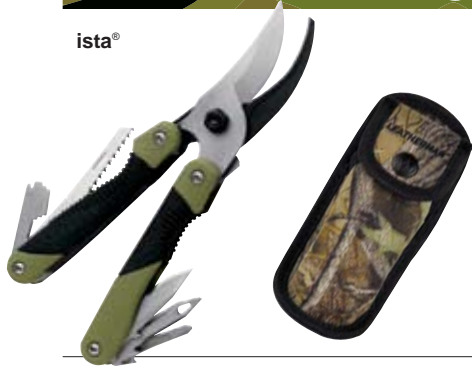

ista®

M LT-F NCT ON TOOLS

LEATHERMAN

Sale Price
Only \$69⁹⁹

Add a Camo Sleeve for \$3.99 Each

9 Tools in One Non-Slip Handles

- Bypass Cutters
- Soft-wire Cutters
- Combo Knife
- Saw
- Awl
- Choke Tube Tool
- Phillips Screwdriver
- Flat Screwdriver
- Bottle Opener

Cat. No.	Description	Sale Price Each
BEQLTG-5	4.7" Multi-Tool	69.99
BEQLTG-10	Nylon Camo Sleeve	3.99

E301 Pocket Knife Multi-Tool

Straight Blade

- Blade Launcher® Opening System
- Thumb Stud
- 420HC Stainless Steel Blade
- Glass-filled Nylon and Rubber Grip
- Carabiner/Bottle Opener
- Removable Pocket Clip



Special Through October 31st, 2009

LEATHERMAN

Sale Price
Cat. No. BEQLTG-45
Only \$27⁹⁹

Gerber Suspension™ Multi-Plier®

The Gerber Suspension has spring-loaded pliers, the patented Saf.T.Plus component locking system, and the very same structural integrity that goes into every Gerber tool.

Components include

- Needle nose pliers
- Wire cutter
- Fine edge knife
- Serrated edge knife
- Saw, scissors
- Crosspoint screwdriver
- Small and medium flatblade screwdrivers
- Can opener
- Bottle opener and lanyard hole.

Technical Specs

Overall Length: 6"
Length Closed: 3.5"
Weight: 6.6 oz.
Handle Material: Stainless Steel
Handle Color: Titanium gray
Sheath: Ballistic Nylon

Sale Price
Cat. No. BEQ180363
Only \$29⁹⁹



GERBER
LEGENDARY DESIGN

Gerber Carnivore Blood Tracking Light™

Sale Price
Cat. No. BEQ180366
Only \$49⁹⁹

The Gerber Carnivore Blood Tracking Light™ has been calibrated across multiple light spectrums in a way that makes the red of blood appear to virtually jump off the ground. A toggle switch lets you operate back and forth between the TRAX LED and the 45 lumen Xenon light. The Carnivore Blood Tracking Light™ combines bright xenon light with TRAX blood tracking technology. If you're the type that likes even your ammo to be camo, the Mossy Oak Carnivore is the blood tracking light for you! Mossy Oak style camouflage has been added to all parts of the light.

FLASHLIGHTS

Key Features

- Light Source Type: One xenon lamp, eight 5mm L.E.D.s
- Output Color: White, Blue/Red
- Output Color Modes: Xenon, Trax
- Output Lumens: 45
- Illumination Distance: 325
- Housing Material: Plastic



GERBER
LEGENDARY DESIGN

Gerber Cornea Torch™



Sale Price
Cat. No. BEQ180367
Only \$19⁹⁹

This stylish, rugged metallic flashlight features adjustable beam functionality, an anodized aluminum housing, and boasts a 40% longer burn time and a 15% longer effective range than its closest competitors. The adjustable beam offers full illumination at its center (no black hole in the middle). The rear tail cap has a lanyard hole and houses the on/off button. Powered by two AA batteries included.

GERBER
LEGENDARY DESIGN

Coiled Hose Polyurethane Air Hose Assemblies

HOSE



New!



Sale Price
As Low As
\$13⁹⁵

Polyurethane air hose assemblies are lightweight and highly kink and abrasion resistant. They will withstand the rigors of tough industrial environments while maintaining their resiliency over a long period of time. Resistant to most oils and fuels. Features include: straight tails that provide built-in whip hose and reusable fittings.

1/4" working pressure rated at 145 PSI @ 75° F
3/8" working pressure rated at 135 PSI @ 75° F

Cat. No.	ID X OD	Lgth.	MPT Fitting	Retracted Length	Sale Price Each
BEQCOL-PR145AB	1/4 x 3/8	5'	1/4 Rigid / 1/4 Swivel	2 1/2 2 1/2	13.95
BEQCOL-PR1410AB	1/4 x 3/8	10'	1/4 Rigid / 1/4 Swivel	2 1/2 6	15.95
BEQCOL-PR1415AB	1/4 x 3/8	15'	1/4 Rigid / 1/4 Swivel	2 1/2 9 1/2	18.95
BEQCOL-PR1420AB	1/4 x 3/8	20'	1/4 Rigid / 1/4 Swivel	2 1/2 13	21.95
BEQCOL-PR1425AB	1/4 x 3/8	25'	1/4 Rigid / 1/4 Swivel	2 1/2 16	24.95
BEQCOL-PR1430AB	1/4 x 3/8	30'	1/4 Rigid / 1/4 Swivel	2 1/2 19	27.95
BEQCOL-PR1450AB	1/4 x 3/8	50'	1/4 Rigid / 1/4 Swivel	2 1/2 32 1/2	48.95
BEQCOL-PR3810AB	3/8 x 9/16	10'	3/8 Rigid / 3/8 Swivel	4 1/8 5 1/2	28.95
BEQCOL-PR3815AB	3/8 x 9/16	15'	3/8 Rigid / 3/8 Swivel	4 1/8 8 1/2	34.95
BEQCOL-PR3820AB	3/8 x 9/16	20'	3/8 Rigid / 3/8 Swivel	4 1/8 11	41.95
BEQCOL-PR3825AB	3/8 x 9/16	25'	3/8 Rigid / 3/8 Swivel	4 1/8 14	48.95
BEQCOL-PR3830AB	3/8 x 9/16	30'	3/8 Rigid / 3/8 Swivel	4 1/8 17	54.95

Neoprene Hose



Sale Price
As Low As
\$7⁹⁹

New!



- Blue neoprene cover with black Nitrile tube
- Flexible, bendable coolant and air hose
- Adjust to any position and won't shift
- Allows air or coolant to be precisely directed to the work area
- RMA Class A-High Oil resistance
- Leakproof and engineered with brass nozzles

Cat.No.	Description	Sale Price Each
BEQCOL-90406	1/4" MPT X 6" Nitrile Hose	7.99
BEQCOL-90409	1/4" MPT X 9" Nitrile Hose	8.99
BEQCOL-90412	1/4" MPT X 12" Nitrile Hose	9.99
BEQCOL-90415	1/4" MPT X 15" Nitrile Hose	10.99

Thermoplastic Hose



New!



Sale Price
As Low As
\$15⁹⁵

Thermoplastic combines prime PVC with special additives allowing this hose to resist long term deterioration caused by exposure to air line lubricating oils. A tough cover protects against scuffs, cuts and abrasions while the rayon spiral synthetic cord assures added strength, making this product a popular choice for industrial environments. Temperature range -20°F to +150°F; working pressure at 70°F 300 PSI

Cat. No.	I.D.	O.D.	Lgth.	Fitting MPT	Sale Price Each
BEQCOL-TP4025	1/4	17/32	25'	1/4" MPT	15.95
BEQCOL-TP4050	1/4	17/32	50'	1/4" MPT	27.95
BEQCOL-TP6025	3/8	57/64	25'	3/8" MPT	19.95
BEQCOL-TP6050	3/8	57/64	50'	3/8" MPT	34.95

High Volume Air Guns and Tips

AIR GUNS AND ACCESSORIES



New!

Sale Price
As Low As
\$16⁹⁵

- Ideal for heavy-duty clean-up and blow-off
- Light weight, sleek design
- Meets or exceeds OSHA regulations
- Has a variable flow trigger for controlled blow-off
- TYP-2500 = 2.1 lbs. thrust, 34 CFM @ 125 PSI
- TYP-3800 = 3.1 lbs. thrust, 51 CFM @ 125 PSI

Cat. No.	Description	Inlet	Sale Price Each
BEQCOL-TYP2500CS	High Flow Tip	1/4	16.95
BEQCOL-TYP2512	12" Extension	1/4	19.95
BEQCOL-TYP2524	24" Extension	1/4	21.95
BEQCOL-TYP2536	36" Extension	1/4	24.95
BEQCOL-TYP2548	48" Extension	1/4	28.95
BEQCOL-TYP3800CS	Multi-Jet with High Flow Tips	3/8	34.95

High Volume Air Gun Tips

Sale Price
As Low As
\$3²⁵



BEQCOL-HFN-00MDL



BEQCOL-HFN00FDL



BEQCOL-MJ0DL

New!

Cat. No.	Description	Sale Price Each
BEQCOL-HFN00MDL	High Flow Tip with Male Pipe Thread	3.25
BEQCOL-HFN00FDL	High Flow Tip with Female Pipe Thread	3.25
BEQCOL-MJ0DL	Multi-Jet Tip (Female)	12.95

EYE PROTECTION



Sperian Womens

New!



Series 100



Series 200



Series 300

**Sale Price
As Low As \$2⁹⁹**

- Designed to fit a woman's profile - narrower width, shorter temples, and slimmer nose bridge
- Hardcoat and anti-fog coatings available
- Great feminine styling
- High impact performance - ANSI Z787+ (high impact) cert.

Cat. No.	Series	Lens Color	Frame Color	Coating	Sale Price Each
BEQ1847735	100	Clear	Clear Frosted	Hardcoat	5.99
BEQ1847736	100	Clear	Clear Frosted	Fog-Ban Anti-Fog	6.49
BEQ1847737	100	Expresso	Brown Frosted	Hardcoat	6.69
BEQ1847738	100	I/O Silver	Clear Frosted	Hardcoat	6.99
BEQ1847739	200	Clear	Dusty Rose	Hardcoat	2.99
BEQ1847740	200	Clear	Dusty Rose	Fog-Ban Anti-Fog	3.29
BEQ1847741	300	Clear	Tortoise Shell	Hardcoat	4.99

Crews Checklite®

- Features exclusive Duramass® scratch resistant and Duramass® anti-fog lens coating
- Strong, lightweight polycarbonate lens filters out 99.9% of U.V. radiation
- Near total seal of eye orbit assures the highest level of protection
- Flexible spatula temple design for a comfortable fit during long use
- Meets or exceeds ANSI Z87.1 safety standards



Clear Coated Lens/
Clear Frame



Grey Lens/
Smoke Frame



Indoor/Outdoor Mirror/
Clear Frame



**Sale Price
As Low As 99¢**

Cat. No.	Lens Color	Frame Color	Sale Price Each
BEQ1840668	Clear Coated	Clear	.99
BEQ1840669	Grey	Smoke	.99
BEQ1840670	Indoor/Outdoor Mirror	Clear	1.39

Moldex Jazz Band®



**Sale Price
Only
\$3⁹⁹**

- A comfortable alternative to muffs
- Optional breakaway neck cord allows the Jazz Band® to conveniently hang around the neck when not in use
- Won't interfere with safety glasses
- Exclusive AdB® coating makes pods soil-resistant
- Spare pods included in each package
- Replacement package contains five pair pods and one neck cord per bag
- NRR 25 (under the chin)



Cat. No.	Description	NRR	Quantity	Sale Price Each
BEQ1840771	Jazz Band®	25	1	3.99
BEQ1840682	Replacement Pods w/Neck Cord	-	5 pairs	1.79

Moldex Camo Plugs™

- Serious protection for serious users
- Different camouflage colors in every package
- Tapered shape for easy fitting and removal
- Non-irritating, smooth surface for added comfort
- NRR 32



**Your Choice
Only \$22⁹⁹**

Cat. No.	Description	NRR	Quantity	Sale Price Each
BEQ1840746	Uncorded Earplugs	32	200 pairs	22.99
BEQ1840747	Corded Earplugs	32	100 pairs	22.99

HAND PROTECTION

Ultra Tech® Latex-Coated Gloves

**Sale Price
Only \$2²⁹**



Stock up now
on gloves
shown here

- Snug elastic fit
- Excellent grip and dexterity
- Cut and puncture protection
- Textured latex over knuckle
- Stretch nylon shell
- 15-gauge

Cat. No.	Description	Size	Sale Price Each
BEQ185283	Ultra Tech® Latex-Coated Glove	S	2.29
BEQ185284	Ultra Tech® Latex-Coated Glove	M	2.29
BEQ185285	Ultra Tech® Latex-Coated Glove	L	2.29

Ultra Tech® Nitrile-Coated Gloves

**Sale Price
Only \$2²⁹**



- Nitrile palm and fingers dip
- Dexterity, cut and puncture protection
- Superior grip, abrasion resistance
- 100% nylon shell
- 15-gauge

Cat. No.	Description	Size	Sale Price Each
BEQ185278	Ultra Tech® Nitrile-Coated Glove	XS	2.29
BEQ185279	Ultra Tech® Nitrile-Coated Glove	S	2.29
BEQ185280	Ultra Tech® Nitrile-Coated Glove	M	2.29
BEQ185281	Ultra Tech® Nitrile-Coated Glove	L	2.29
BEQ185282	Ultra Tech® Nitrile-Coated Glove	XL	2.29

2265 Black Creek Road
Muskegon, MI 49444-2684

CHANGE SERVICE REQUESTED

PRSRT STD
U.S. POSTAGE
PAID
RAVENNA, MI
PERMIT NO. 320

Postmaster please deliver between 8/25/09 — 9/1/09

Mailroom: If the addressee is no longer at this address, please email to mail@ReidSupply.com or fax corrections to 800.438.1145.

Re-route to:

- Engineering
- Tool Room
- Purchasing

Customer #



Contact ID

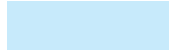

Reid Customer Service is here to help you, Monday through Friday from 7 a.m. to 8 p.m. EST.

PRINTED IN THE USA 9-02-05-05 Promo Code BEQ

SAVINGS SPOTLIGHT

Prices Effective September 1 - October 31, 2009

Fast Orange®
Hand Cleaner
As Low As
\$14.99
Page 11

Fractional Digital Caliper
As Low As
\$19.99
Page 10

Machinist's
Calculator
Only
\$38.95
Page 12

Vertical Handle
Hold-Down
Clamps
As Low As
\$11.99
Page 5